

AMENDMENTS:		
AMENDMENT	DATE	DESCRIPTION

NOTES:

- 1) This plan has been prepared for sewer asbuilt purposes only. No liability is accepted if the plan is used for any other purpose.
- 2) Any measurements taken from information which is not dimensioned on the electronic copy are at the risk of the recipient.
- 3) All sewer laterals are Ø100mm uPVC SN16. All Ø150mm uPVC sewer mains are SN16.
- 4) All lateral positions have been provided by Rooney Group Ltd and have not been verified. No liability is accepted in relation to their locations.
- 5) Origin of Levels:
IT III DP 21305
Stainless steel pin flush in sealed road shoulder
RL=8.923m

Levels are in terms of New Zealand Vertical Datum 2016 (NZVD 2016)

LEGEND

LL= LID LEVEL
IL= INVERT LEVEL

SANITARY SEWER: ———— MH ———— SEWER LATERAL
EXISTING SANITARY SEWER: - - - - - EX.MH - - - - - EX.SEWER LATERAL

ASBUILT KERB AND CHANNEL: ———— CUTDOWN
ASBUILT FOOTPATH: ————

DAVIE LOVELL-SMITH
PLANNING SURVEYING ENGINEERING

116 Wrights Road P O Box 679 Christchurch 8140, New Zealand
Telephone: 03 379-0793 Website: www.dis.co.nz E-mail: office@dis.co.nz

JOB TITLE:
Rosemerryn - Stage 24

SHEET TITLE:
Sewer Asbuilt

DRAWING STATUS:
Asbuilt

SCALE: 1:500@A1 DATE: March 2026
1:1000@A3

CAD FILE: J:\21373\ASBUILTS\E21373_STG24_AB_NZTM NZV16 RD.dwg DRAWN: SC
DRAWING No: SHEET No: REVISION:
E.21373.AB.SS01 RO

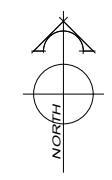
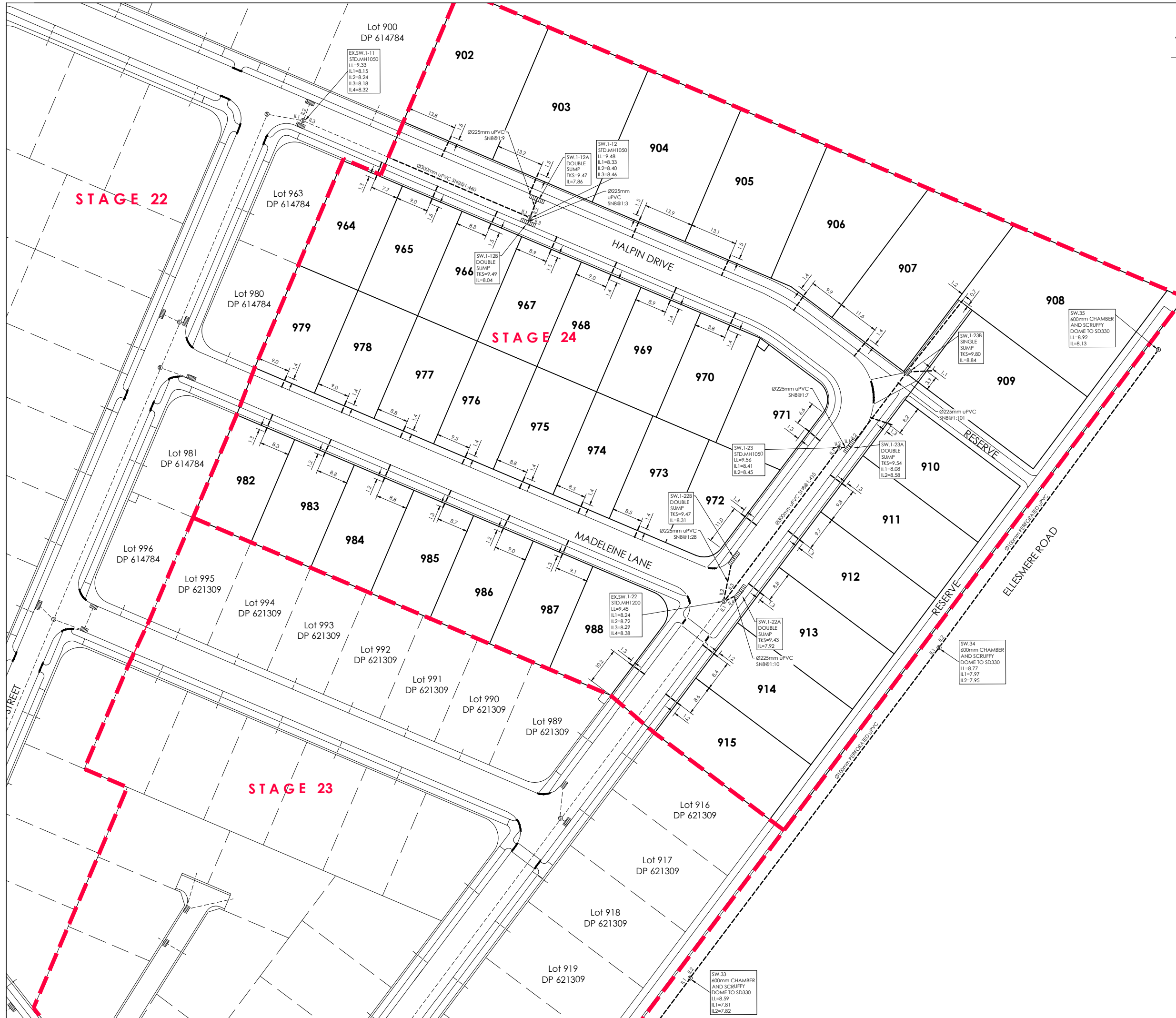

AMENDMENTS:		
AMENDMENT	DATE	DESCRIPTION

- NOTES:
- 1) This plan has been prepared for stormwater asbuilt purposes only. No liability is accepted if the plan is used for any other purpose.
 - 2) Any measurements taken from information which is not dimensioned on the electronic copy are at the risk of the recipient.
 - 3) All connections to kerb adaptors are evident on site.
 - 4) All stormwater pipes up to Ø525mm are uPVC SN8. All concrete pipes are Class 4.
 - 5) All stormwater laterals are Ø100mm uPVC SN16.
 - 6) Stormwater pipe locations and levels have been provided by Rooney Group Ltd and have not been verified. No liability is accepted in relation to their accuracy.
 - 7) Origin of Levels:
 IT III DP 21305
 Stainless steel pin flush in sealed road shoulder
 RL=8.923m

Levels are in terms of New Zealand Vertical Datum 2016 (NZVD 2016)

LEGEND

LL=	LID LEVEL
IL=	INVERT LEVEL
TKS=	TOP OF KERB LEVEL AT SUMP
STORMWATER	
EXISTING STORMWATER	
ASBUILT KERB AND CHANNEL	
ASBUILT FOOTPATH	

DAVIE LOVELL-SMITH
 PLANNING SURVEYING ENGINEERING

116 Wrights Road P O Box 679 Christchurch 8140, New Zealand
 Telephone: 03 379-0793 Website: www.dls.co.nz E-mail: office@dls.co.nz

JOB TITLE:
Rosemerryn - Stage 24

SHEET TITLE:
Stormwater Asbuilt

DRAWING STATUS:
Asbuilt

SCALE: 1:500@A1
 1:1000@A3 DATE: March 2026

CAD FILE: J:\21373\ASBUILTS\E21373_STG24_AB_NZTM NZV16 RD.dwg DRAWN: SC
 DRAWING No: SHEET No: REVISION:
E.21373.AB.SW01 RO

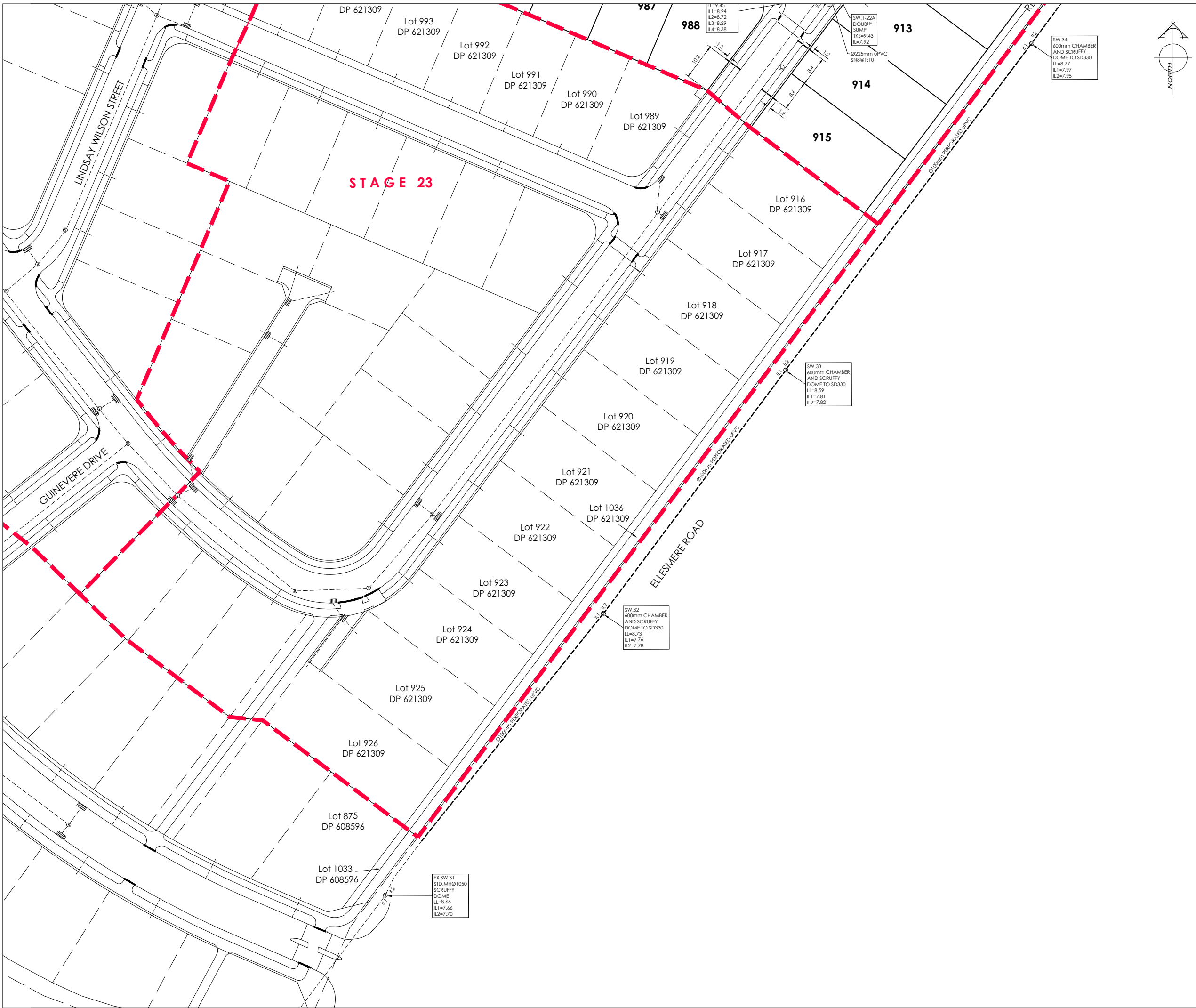

AMENDMENTS:		
AMENDMENT	DATE	DESCRIPTION

NOTES:

- 1) This plan has been prepared for stormwater asbuilt purposes only. No liability is accepted if the plan is used for any other purpose.
- 2) Any measurements taken from information which is not dimensioned on the electronic copy are at the risk of the recipient.
- 3) All connections to kerb adaptors are evident on site.
- 4) All stormwater pipes up to Ø525mm are uPVC SN8. All concrete pipes are Class 4.
- 5) All stormwater laterals are Ø100mm uPVC SN16.
- 6) Stormwater pipe locations and levels have been provided by Rooney Group Ltd and have not been verified. No liability is accepted in relation to their accuracy.
- 7) Origin of Levels:
 IT III DP 21305
 Stainless steel pin flush in sealed road shoulder
 RL=8.923m

Levels are in terms of New Zealand Vertical Datum 2016 (NZVD 2016)

LEGEND

LL= LID LEVEL
 IL= INVERT LEVEL
 TKS= TOP OF KERB LEVEL AT SUMP

STORMWATER

EXISTING STORMWATER

ASBUILT KERB AND CHANNEL

ASBUILT FOOTPATH

MH

EX.MH

SUMP DOUBLE SUMP CUTDOWN

DAVIE LOVELL-SMITH
 PLANNING SURVEYING ENGINEERING

116 Wrights Road P O Box 679 Christchurch 8140, New Zealand
 Telephone: 03 379-0793 Website: www.dls.co.nz E-mail: office@dls.co.nz

JOB TITLE:

Rosemerryn - Stage 24

SHEET TITLE:

Stormwater Asbuilt

DRAWING STATUS:

Asbuilt

SCALE: 1:500@A1 DATE: March 2026
 1:1000@A3

CAD FILE: J:\21373\ASBUILTS\E21373_STG24_AB_NZTM NZV16 RD.dwg DRAWN: SC

DRAWING No: SHEET No: REVISION:

E.21373.AB.SW02 **RO**

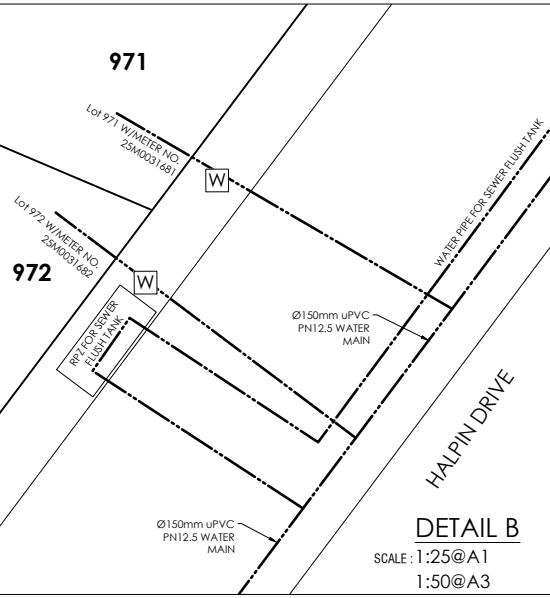
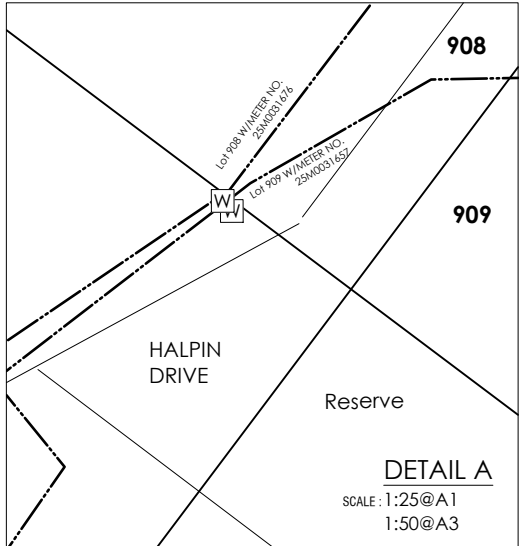
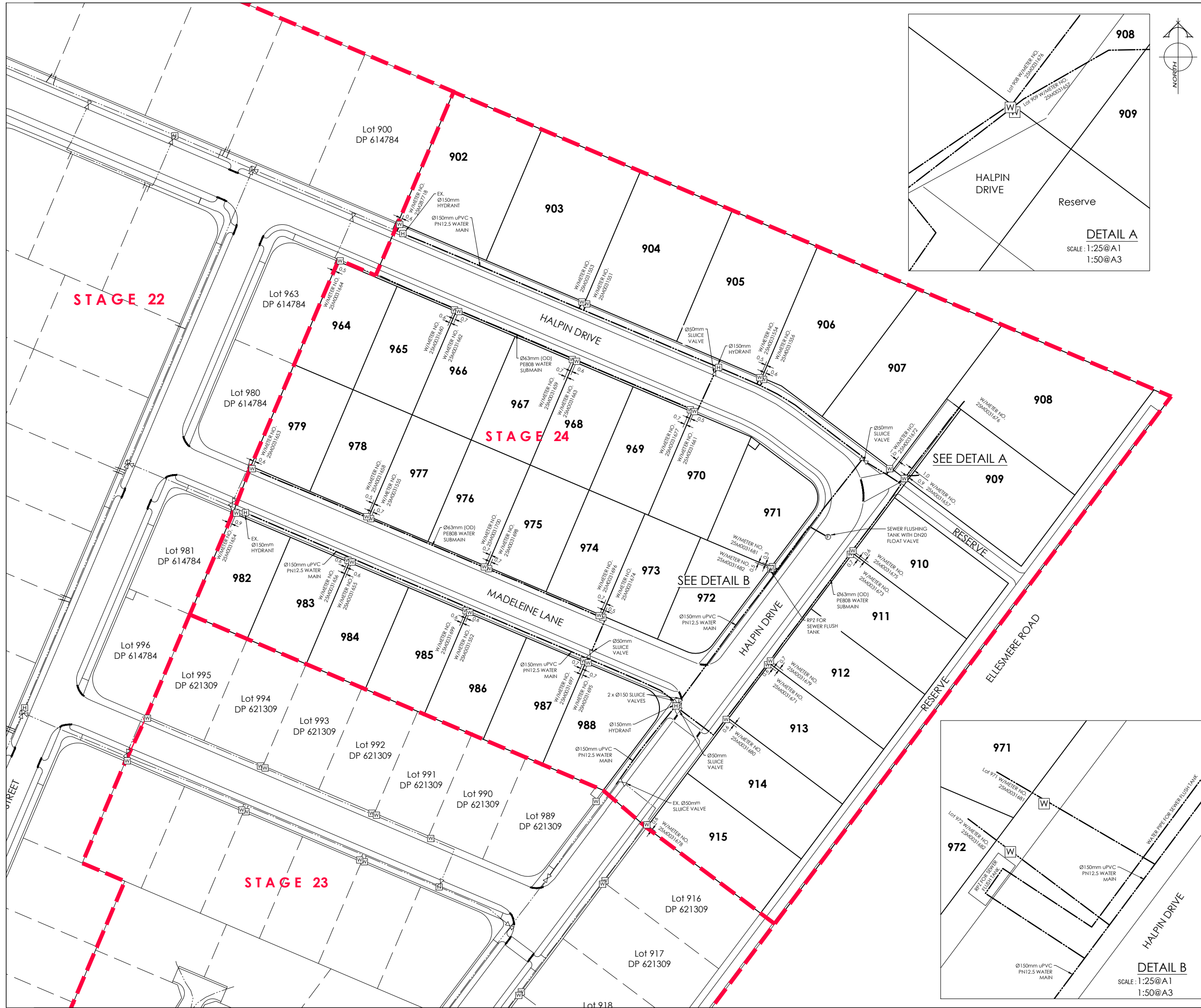

AMENDMENTS:		
AMENDMENT	DATE	DESCRIPTION

- NOTES:
- 1) This plan has been prepared for water asbuilt purposes only. No liability is accepted if the plan is used for any other purpose.
 - 2) Any measurements taken from information which is not dimensioned on the electronic copy are at the risk of the recipient.
 - 3) All submains are Ø63mm (OD) PE BlueLine PN12.5 with associated fittings.
 - 4) All house connections are 25mm poly and include gate valve, toby box, tapping band and ferrule.
 - 5) All water laterals are Ø25mm PE BlueLine PN12.5 with associated fittings unless otherwise specified.
 - 6) All watermains are uPVC PN12.
 - 7) The locations of submains and watermains have been provided by Rooney Group Ltd. No liability is accepted in relation to their accuracy.

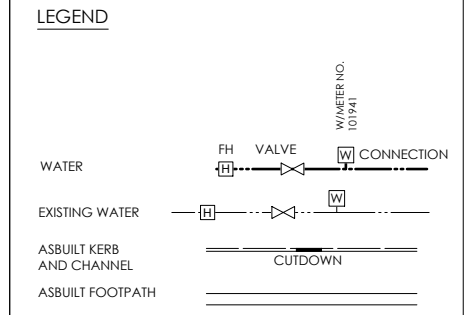

DAVE LOVELL-SMITH
PLANNING SURVEYING ENGINEERING

116 Wrights Road P O Box 679 Christchurch 8140, New Zealand
Telephone: 03 379-0793 Website: www.dls.co.nz E-mail: office@dls.co.nz

JOB TITLE:		Rosemerryn - Stage 24	
SHEET TITLE:		Water Asbuilt	
DRAWING STATUS:		Asbuilt	
SCALE: 1:500@A1 1:1000@A3	DATE: March 2026	DRAWN: SC	
CAD FILE: J:\21373\ASBUILTS\E21373_STG24_AB_NZTM NZV16 RD.dwg	DRAWING No: E.21373.AB.WS01	SHEET No:	REVISION: RO

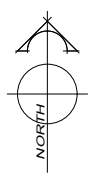

AMENDMENTS:		
AMENDMENT	DATE	DESCRIPTION

- NOTES:
1. This plan has been prepared for road asbuilt purposes only. No liability is accepted if the plan is used for any other purpose.
 2. Any measurements taken from information which is not dimensioned on the electronic copy are at the risk of the recipient.
 3. Carriageway dimensions shown are from face of kerb to face of kerb.

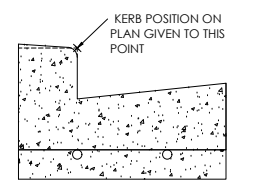

KERB & CHANNEL TO SD601

LEGEND

- HYDRANT LOCATION
- STREET LIGHT
- EXPOSED AGGREGATE CONCRETE
- ASBUILT KERB AND CHANNEL
- ASBUILT FOOTPATH
- CUTDOWN



116 Wrights Road P O Box 679 Christchurch 8140, New Zealand
 Telephone: 03 379-0793 Website: www.dls.co.nz E-mail: office@dls.co.nz

JOB TITLE:
Rosemerryn - Stage 24

SHEET TITLE:
Roading Asbuilt

DRAWING STATUS:
Asbuilt

SCALE: 1:500@A1 DATE: March 2026
 1:1000@A3

CAD FILE: J:\21373\ASBUILTS\E21373_STG24_AB_NZTM NZV16 RD.dwg DRAWN: SC
 DRAWING No: SHEET No: REVISION:
E.21373.AB.RD01 RO

AMENDMENTS :		
AMENDMENT	DATE	DESCRIPTION

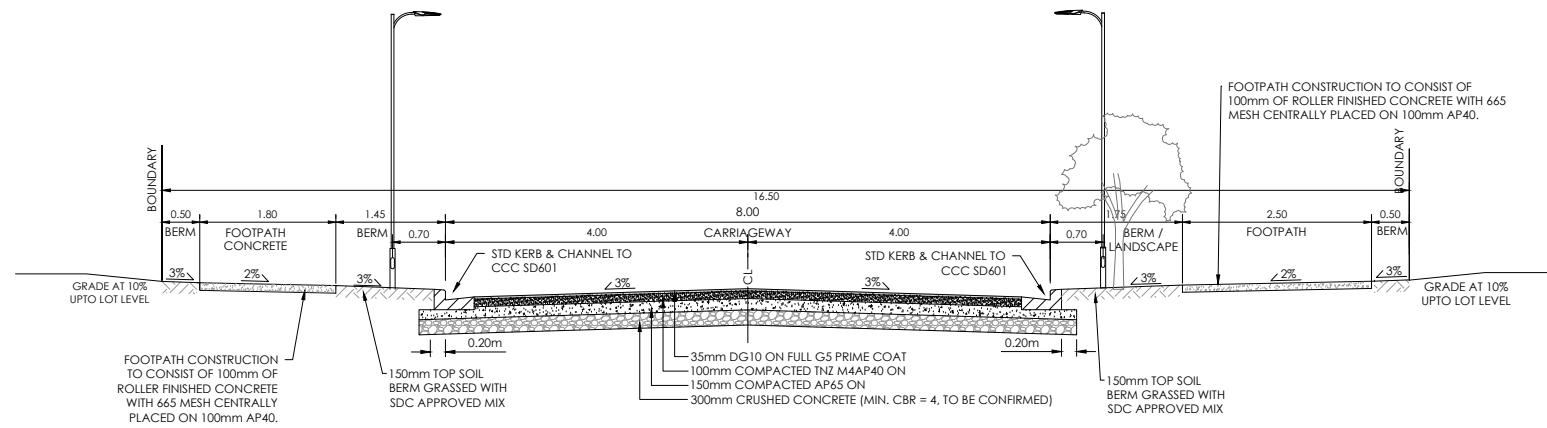

TYPICAL CROSS SECTION 16.5m HALPIN DRIVE
NORTH SECTION
 SCALE 1:50@A1
 1:100@A3

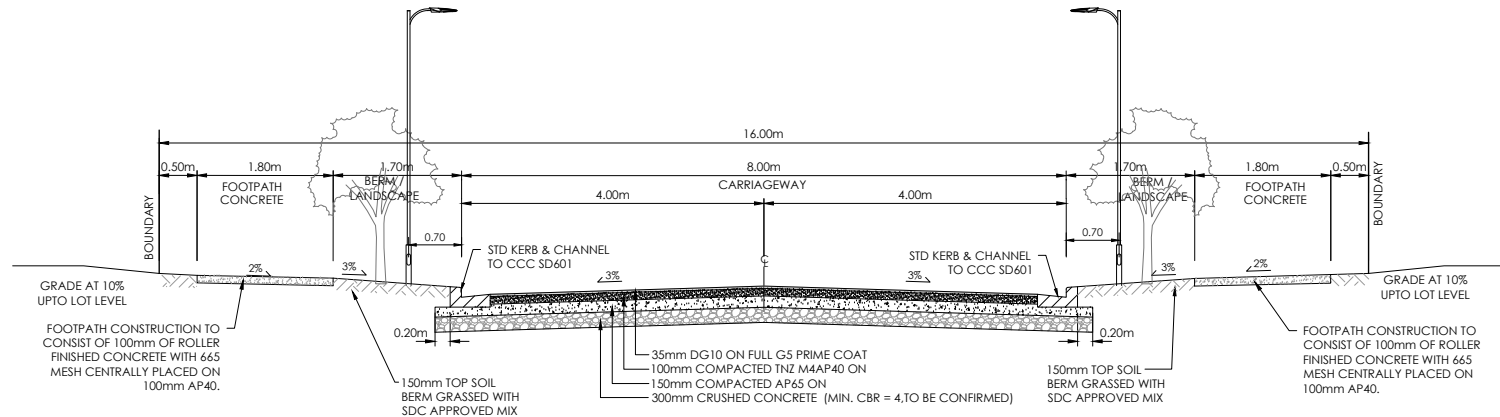

TYPICAL CROSS SECTION 16m HALPIN DRIVE
SOUTH-EAST SECTION
 SCALE 1:50@A1
 1:100@A3

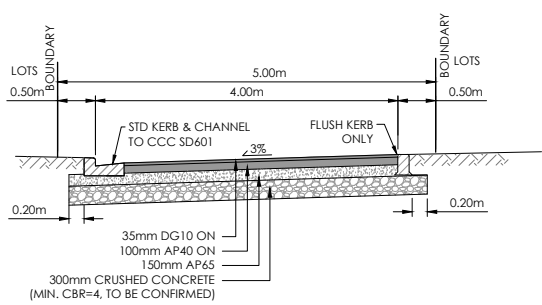

TYPICAL CROSS SECTION ACCESS (ROW 1)
 SCALE 1:50@A1
 1:100@A3

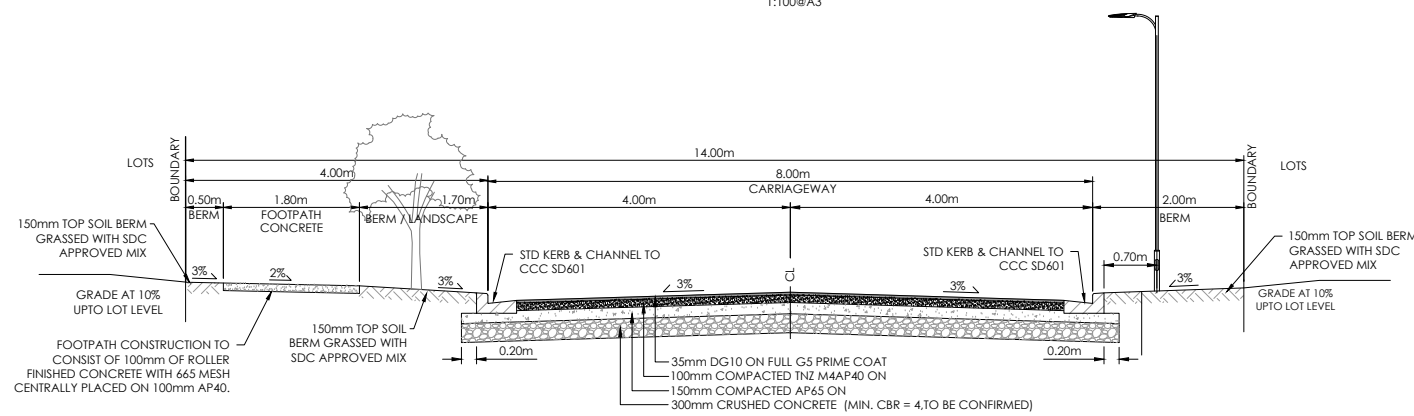

TYPICAL CROSS SECTION 14m
MADELEINE LANE
 SCALE 1:50@A1
 1:100@A3



116 Wrights Road P O Box 679 Christchurch 8140, New Zealand
 Telephone: 03 379-0793 Website: www.dls.co.nz E-mail: office@dls.co.nz

JOB TITLE:
Rosemerryn - Stage 24

SHEET TITLE:
Roading Sections

DRAWING STATUS:
Asbuilt

SCALE : As Shown DATE : March 2026

GAD FILE : J:\21373\ASBUILTS\E21373_STG24_AB_NZTM NZV16 RD.dwg DRAWN: SC
 DRAWING No : SHEET No: REVISION :
E.21373.AB.RD02 RO